

PYRAMID BASE FLASHING - SECTION VIEW

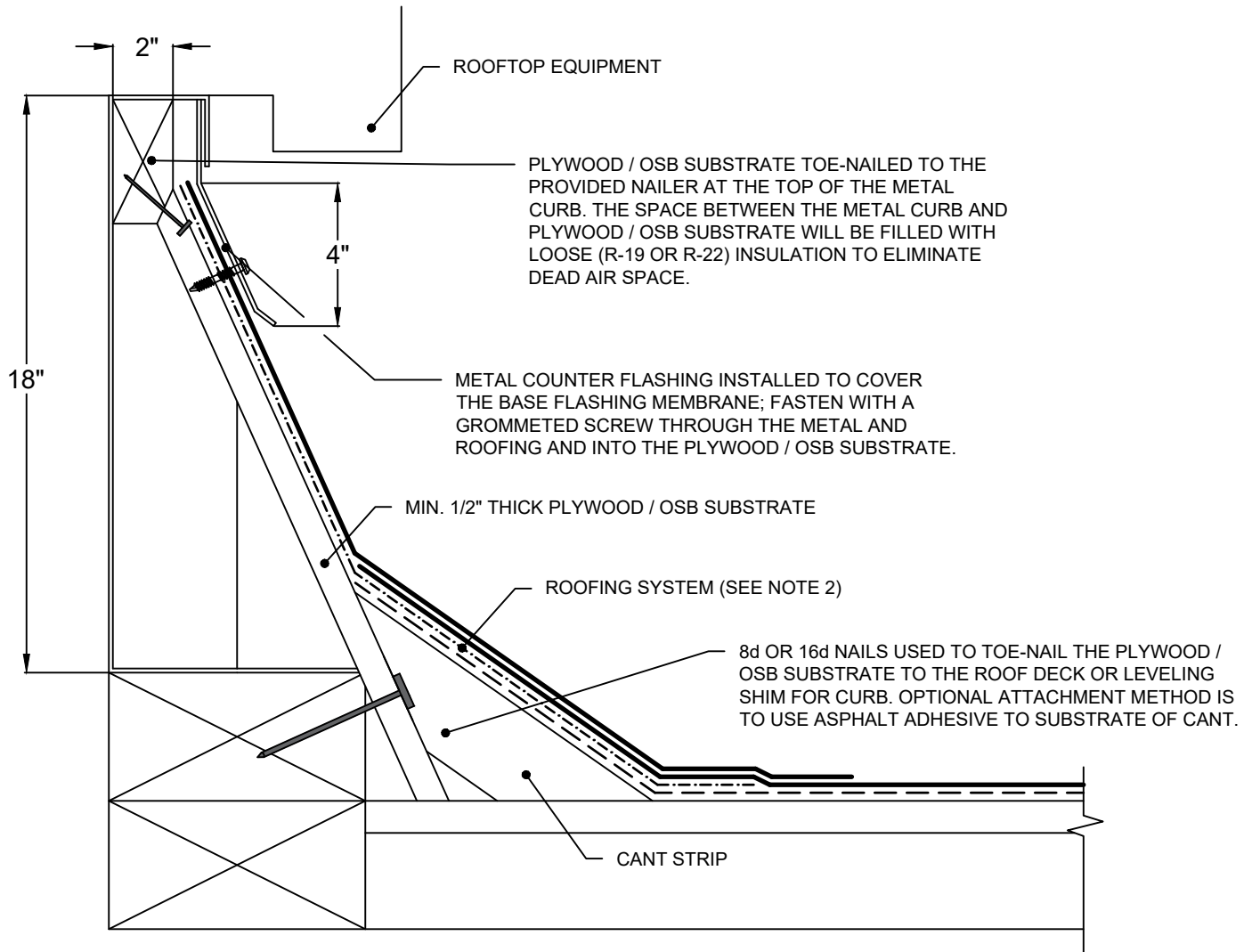

NOTES:

1. THIS DETAIL IS RECOMMENDED FOR USE AS AN ALTERNATIVE TO DUAL-CANTED BASE FLASHING. DUAL-CANTED BASE FLASHING CAN BRIDGE ONCE ELEVATED ROOF TEMPERATURES OCCUR.
2. ROOFING SYSTEM IS COMPOSED OF: 1) FIELD BASE / INTERPLY INSTALLED TO TOP OF CANT; 2) STRIPPING / BACKER PLY DOWN FROM INCLINE AND 3" PAST TOE OF CANT; 3) FIELD CAP SHEET TO TOP OF CANT; AND 4) BASE FLASHING CAP SHEET DOWN FROM INCLINE AND 6" PAST TOE OF CANT.

LOW SLOPE 27 - SEC



Rev. 8/21

PROJECT NAME:

ADDRESS:

OWNER:

DATE:

SCALE: NOT TO SCALE

PROJECT NO:

DRAWING NO. :

SUBMITTAL NO. :