

LEAD PIPE FLASHING - SECTION VIEW

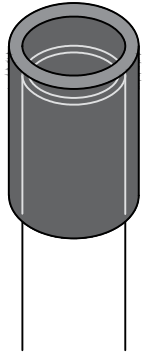

OPTION 1:

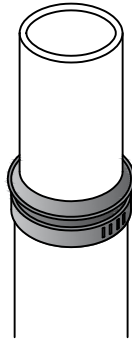

OPTION 2:

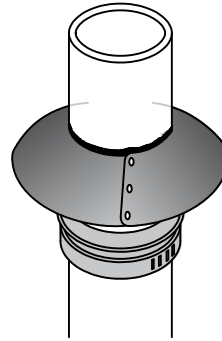

OPTION 3:

OPTION 1:
INSTALL A LEAD CAP TO COVER THE TOP OF THE LEAD FLASHING A MINIMUM OF 1".

OPTION 2:
INSTALL A BAND CLAMP; TIGHTEN AND SEAL THE TOP OF THE FLASHING USING URETHANE CAULKING.

OPTION 3:
FOR ADDITIONAL PROTECTION FOLLOWING INSTALLATION OF A BAND CLAMP WITH SEALANT (OPTION 2), ADD A STORM COLLAR ABOVE THE BAND CLAMP AND SEAL THE TOP OF THE COLLAR TO THE PIPE PENETRATION.

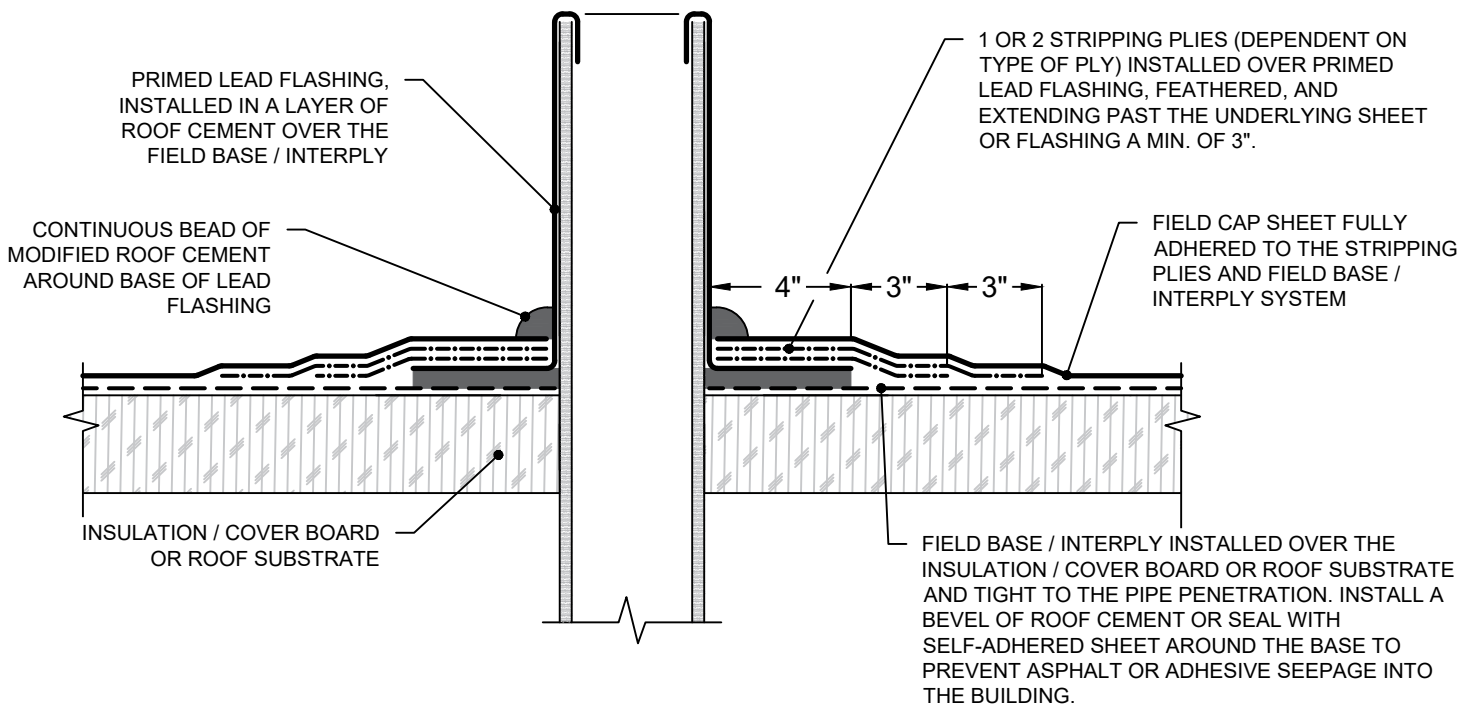

LOW SLOPE 16 - SEC



Rev. 12/21

PROJECT NAME:

ADDRESS:

OWNER:

DATE:

SCALE: NOT TO SCALE

PROJECT NO.:

DRAWING NO. :

SUBMITTAL NO. :