

# END CAP

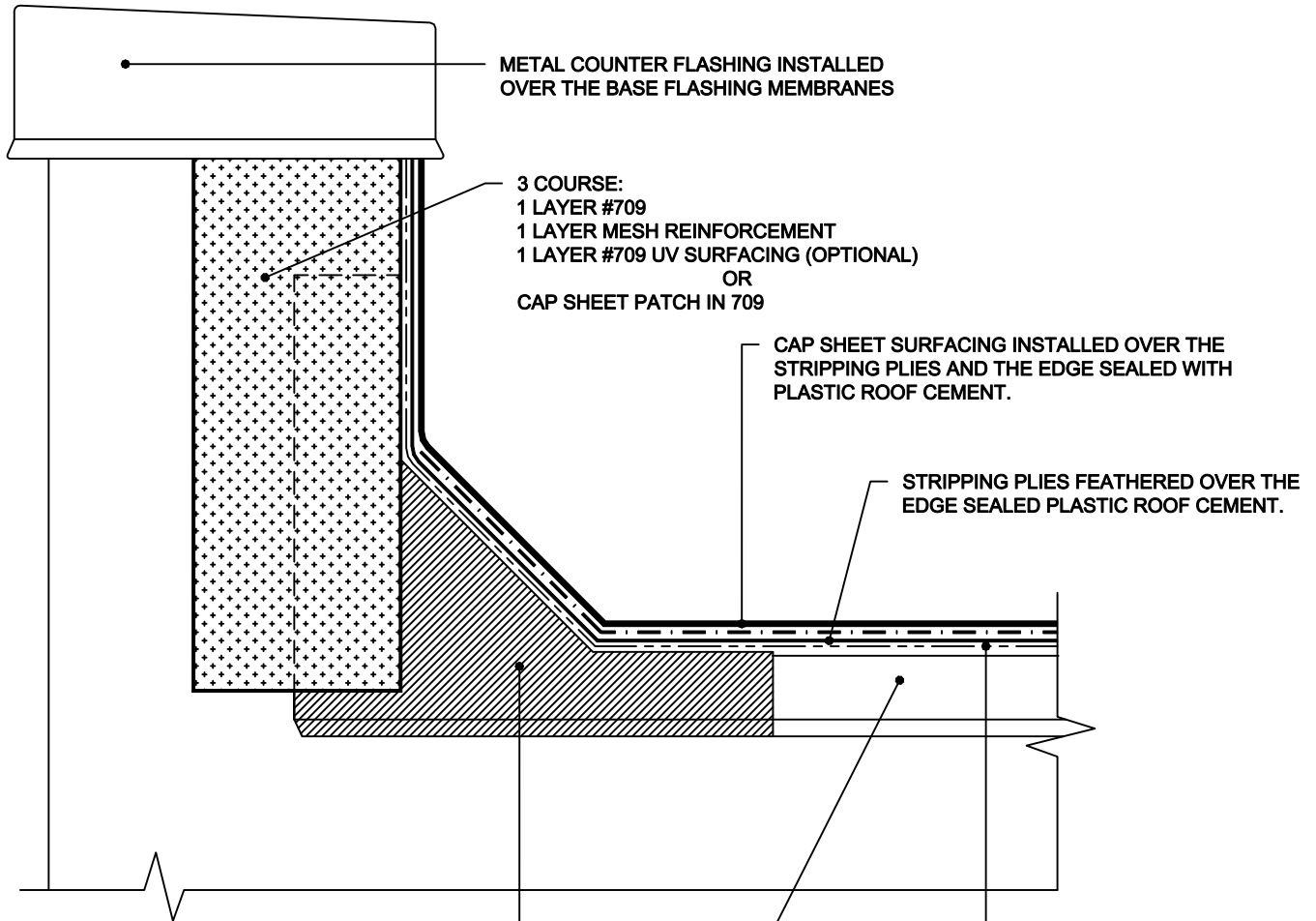

METAL COUNTER FLASHING INSTALLED OVER THE BASE FLASHING MEMBRANES

3 COURSE:  
 1 LAYER #709  
 1 LAYER MESH REINFORCEMENT  
 1 LAYER #709 UV SURFACING (OPTIONAL)  
 OR  
 CAP SHEET PATCH IN 709

CAP SHEET SURFACING INSTALLED OVER THE STRIPPING PLYS AND THE EDGE SEALED WITH PLASTIC ROOF CEMENT.

STRIPPING PLYS FEATHERED OVER THE EDGE SEALED PLASTIC ROOF CEMENT.

SHEET METAL END CAP, MADE LIKE THE PROFILE OF THE EDGE METAL OR GRAVEL GUARD WITH AN INCORPORATED CANT AND 4" ROOF SIDE FLANGE TO ALLOW FOR THE STRIPPING OFF WITH BASE FLASHING MEMBRANES.

PRIME LOW-RISE GRAVEL STOP OR EDGE METAL SET OVER THE BASE / INTER-PLY IN A LAYER OF PLASTIC ROOF CEMENT.

BASE SHEET, INSTALLED OVER THE INSULATION / COVER BOARD OR ROOF SUBSTRATE AND TURNED DOWN THE EDGE 1/4" BEYOND THE THICKNESS OF THE NAILER.

# LOW SLOPE V

PROJECT NAME:

DATE:

SCALE: NOT TO SCALE

PROJECT NO:

ADDRESS:

DRAWING NO. :

OWNER:

SUBMITTAL NO. :