

# SCUPPER

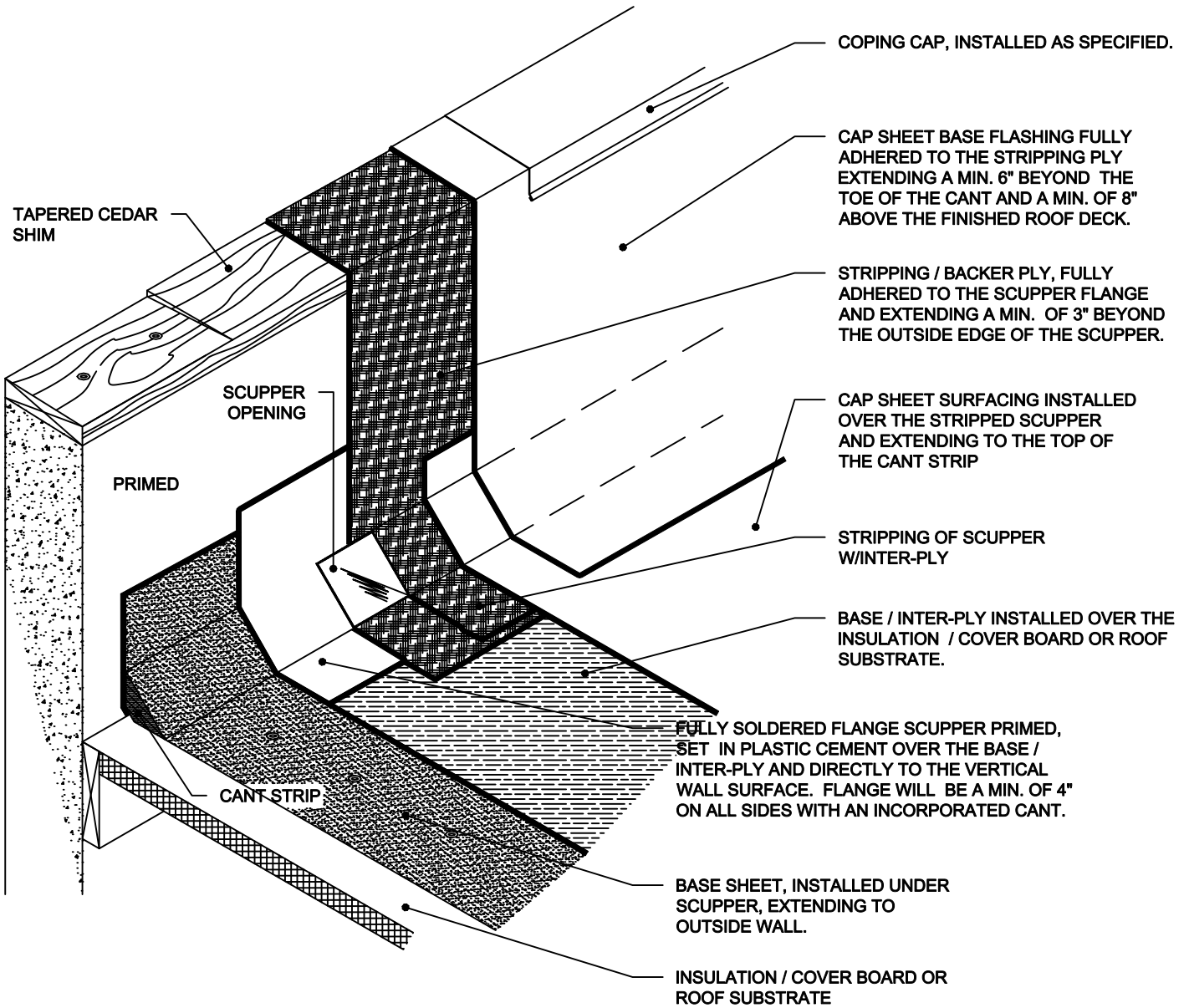

## LOW SLOPE R

### NOTES:

- SCUPPER WILL BE MADE TO ALLOW MINIMAL DISTANCE BETWEEN THE SCUPPER AND THE OPENING.
- OUTER TUBE OF THE SCUPPER SHOULD EXTEND A MIN. OF 1" BEYOND THE OUTSIDE OF THE WALL.
- MALARKEY DOES NOT ENDORSE THE USE OF THROUGH WALL SCUPPERS THAT LACK TWO ROOF SIDE FLANGES. WHEN THROUGH WALL SCUPPER IS SPECIFIED, FIELD SOLDERED A LEAD FLANGE TO THE OUTER TUBE TO ALLOW FOR THE SCUPPER TO BE STRIPPED IN FROM THE OPPOSING ROOF DECK.
- FOR NON- LEAD FLANGED ROOF SCUPPERS THAT REQUIRE MECHANICAL ATTACHMENT: INSTALL PRESSURE-TREATED WOOD BLOCKING TO THE ROOF DECK, DIRECTLY UNDER THE SCUPPER AREA TO ALLOW FOR MECHANICAL ATTACHMENT.

PROJECT NAME:

DATE:

SCALE: NOT TO SCALE

PROJECT NO:

ADDRESS:

DRAWING NO. :

OWNER:

SUBMITTAL NO. :