

HIGH WOOD WALL BASE FLASHING

CAP TERMINATION OPTION 1:
 INSTALL WATERPROOFING PLY (ARCTIC SEAL 401 OR CAP SHEET MEMBRANE) BELOW THE WOOD NAILER AND CAP.

CAP TERMINATION OPTION 2:
 NAIL OFF THE BASE FLASHING AT THE TOP OF THE WALL AND THREE COURSE WITH 709 MODIFIED AND WEB REINFORCEMENT OR INSTALL EZ SEAL NON-FIBERED SYSTEM.

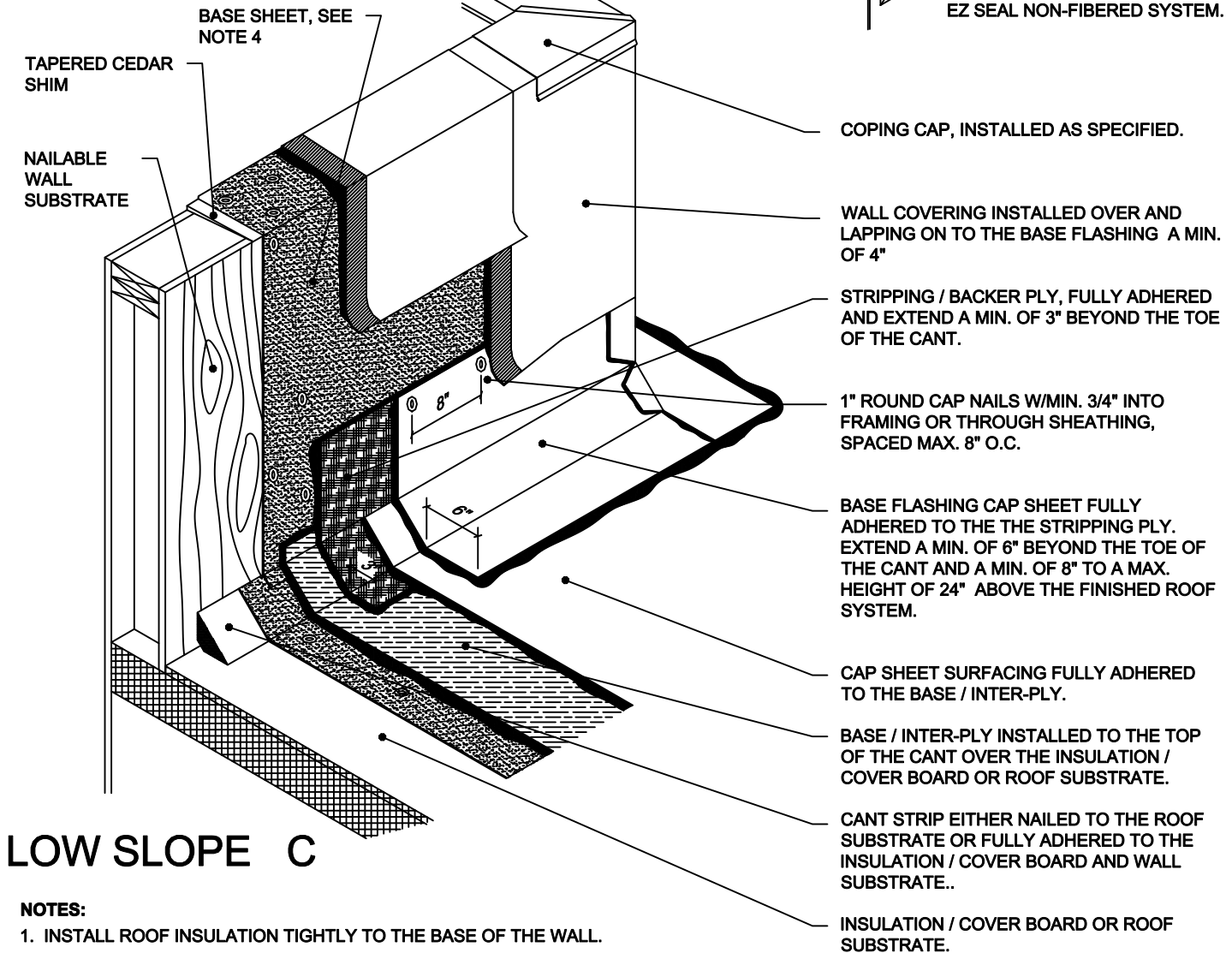

LOW SLOPE C

NOTES:

1. INSTALL ROOF INSULATION TIGHTLY TO THE BASE OF THE WALL.
2. INSTALL CANT STRIP AT THE ROOF TO THE WALL TRANSITION.
3. INSTALL BASE / INTER-PLY ROOFING SYSTEM TO THE TOP OF THE CANT.
4. INSTALL BASE SHEET TO THE VERTICAL SURFACE OF THE WALL. SPRINKLE MOP THE BACK SIDE OF THE BASE SHEET AND RUB ONTO THE VERTICAL SURFACE OF THE WALL THEN NAIL, USING 1" GALVANIZED CAP NAILS 12" ON CENTER IN EVERY DIRECTION. FULLY ADHERE STRIPPING /BACKER PLY TO THE MECHANICALLY ATTACHED BASE SHEET.
5. INSTALL CAP SHEET OVER THE STRIPPING / BACKER PLY TO THE TOP OF THE CANT.
6. INSTALL BASE FLASHING CAP SHEET A MIN. OF 6" BEYOND THE TOE OF THE CANT AND ABOVE THE FINISHED ROOF SYSTEM A MIN. OF 8" TO A MAX. OF 24". TERMINATE THE TOP OF THE BASE FLASHING USING 1" GALVANIZED CAP NAILS. INSTALL CAP NAILS 1/2" BELOW THE TOP OF THE BASE FLASHING KICKER, WITH GALVANIZED CAP NAILS 8" ON CENTERS.
7. INSTALL WALL COVERING AS ILLUSTRATED ABOVE. THE RECOMMENDED ADHESIVE FOR THE WALL COVERING IS MALARKEY'S 709 MODIFIED FLASHING CEMENT FOR BUR AND SBS SYSTEMS AND TORCH APPLIED MEMBRANE FOR APP.

PROJECT NAME:

DATE:

SCALE: NOT TO SCALE

ADDRESS:

PROJECT NO:

DRAWING NO. :

OWNER:

SUBMITTAL NO. :